

DIMENSIONS

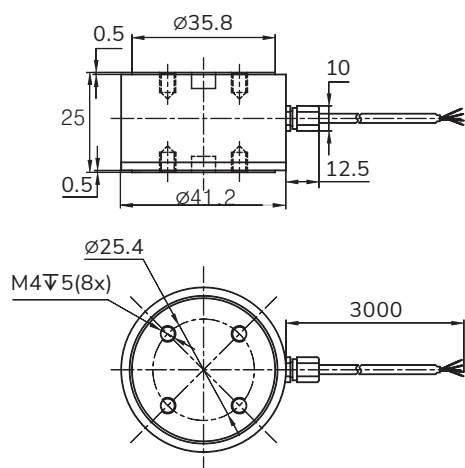

CAPACITIES

CAP (Kg) 10/20/50/100/200/500

SPECIFICATIONS

PERFORMANCE	
Non-Linearity	$\pm 0.1\%$ of RO
Hysteresis	$\pm 0.1\%$ of RO
Repeatability	$\pm 0.1\%$ of RO
Creep (30min)	$\pm 0.05\%$ of RO
Zero Balance	$\pm 2\%$ of RO
ELECTRICAL	
Rated Output	$2.0 \pm 1\%$ mV/V
Recommended Excitation	5 ~ 10 VDC
Insulation	≥ 5000 M Ω / 100 VDC
Cable Color Code	Input : Red (E+) Black (E-) Output : Green (S+) White (S-)
MECHANICAL	
Weight	0.2Kg
Safe Overload	150% of RO
Ultimate Overload	200% of RO
Material	Stainless Steel
Cable Size	$\varnothing 3 \times 3000$ mm
IP Rating	IP54
TEMPERATURE	
Operating Temperature	-30 ~ 70°C
Temp. Effect On Output	$\pm 0.5\%$ of RO / 10°C
Temp. Effect On Zero	$\pm 0.5\%$ of RO / 10°C
CONFORMITY	
RoHS	2011/65/EU
CE	2014/35/EU



FEATURES & APPLICATIONS

- For In Line Use In Both Tension And Compression
- Low Deflection
- Fast Response Time
- Superior Natural Frequency
- Small Profile For Tight Spaces
- Suitable For Tension And Compression Situations Of Various Pressure-Holding Equipment

LOAD DIRECTION

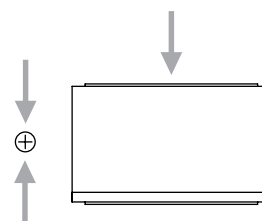

SCHEMATIC WIRING DIAGRAM

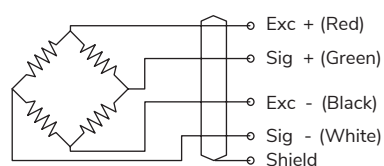

Note: Cable shield is not connected to element.