

# MT2E1

## Cable-Actuated Position Sensor Incremental Encoder Output • Test Applications

소형 스트링 포트 • 0–30 및 0–50인치 스트로크 범위 옵션  
이중 축 360° 장착 브래킷  
낙하 및 충돌 테스트 애플리케이션  
알루미늄 및 폴리카보네이트 인클로저



MT2E1은 견고하고 정확한 소형 케이블 작동 위치 변환기 제품군의 인코더 기반 제품입니다. MT2E1은 낙하 테스트 및 자동차 충돌 테스트에서 발생하는 높은 가속 요구 사항을 위해 설계된 고장력 헤비 듀티 측정 케이블을 특징으로 합니다.

MT2E1은 마운팅 브래킷에서 2축 360° 회전으로 설계되어 어떤 방향으로든 빠르고 간단하게 설치할 수 있습니다.

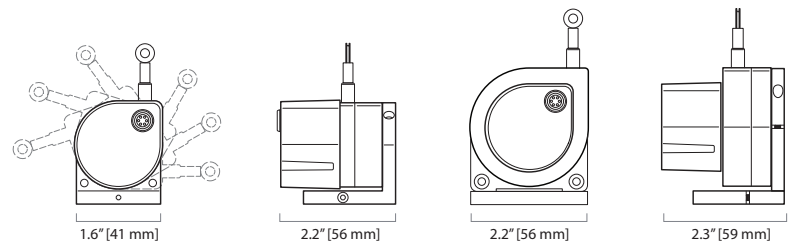

30 inch

50 inch

### GENERAL

**Full Stroke Range Options**

**Output Signal**

**Accuracy**

**Repeatability Resolution:**

0-30, 0-50 inches  
incremental encoder  
0.04% full stroke  
± 0.02% full stroke

### 30-inch Range

**50-inch Range**

**Measuring Cable**

**Enclosure Material**

**Sensor Cover Options**

**Sensor**

**Weight, 30-inch**

**Weight, 50-inch**

316 ± 5 pulses per inch  
188 ± 2 pulses per inch  
Ø.019-in. nylon-coated stainless steel  
anodized aluminum  
polycarbonate and aluminum optical  
incremental encoder  
0.5 lb. max.  
1.0 lb. max.

### ELECTRICAL

**Input Voltage, Vin**

**Input Current**

**Output Driver**

**Output Voltage,**

**Vout Mating Plug**

5 - 26 VDC  
50 mA (max, no load)  
push-pull (sink/source, 20mA max.)  
Vout = Vin  
LEMO FGG.OB.304.CLAD52

### MECHANICAL

**Measuring Cable Tension**

**Maximum Acceleration**

see ordering information  
see ordering information

### ENVIRONMENTAL

**Operating Temperature**

-32° to 158° F (0° to 70°C)

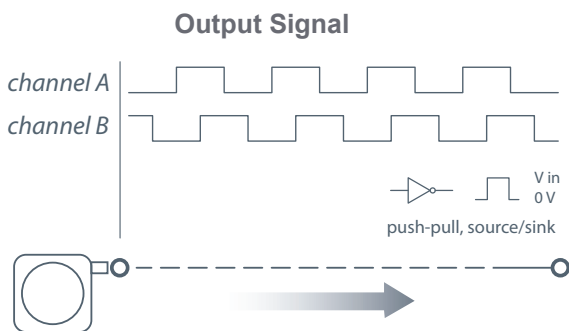

Fig. 1 - Outline Drawing, 30-inch range:

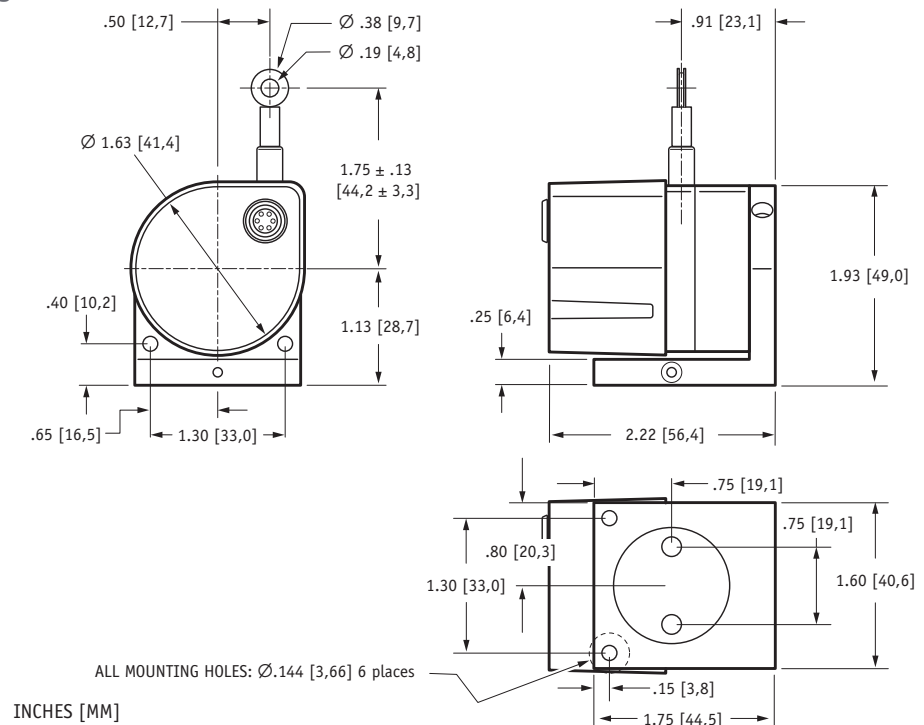
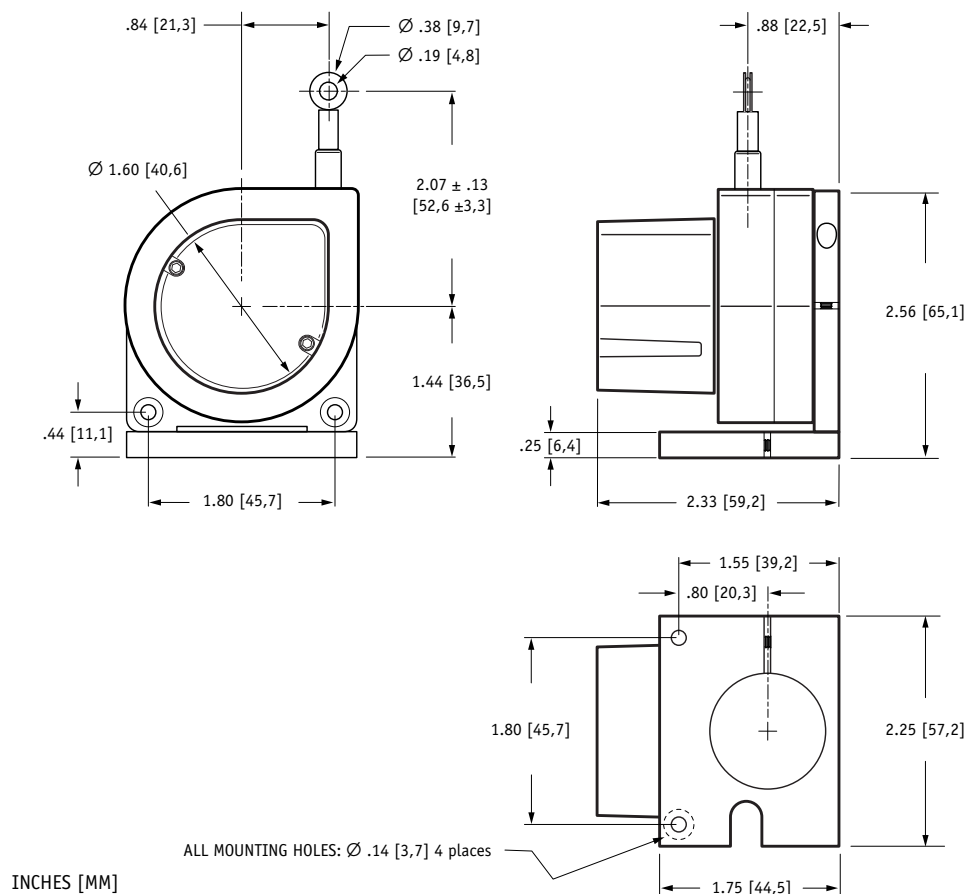

Fig. 2 - Outline Drawing, 50-inch range:



## Ordering Information:

### Model Number:

#### 30-inch Ordering Guide

**MT2E1 - 30**     A     -     B     - **316** -     C    

order code:

Sample Model Number:

**MT2E1 - 30E - 33 - 316 - M1**

**R** range: 30 inches  
**A** measuring cable termination: eyelet  
**B** measuring cable tension: 33 oz. (±6 oz.)  
**C** electrical connection: end-mounted connector

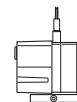

see fig. 1

#### 50-inch Ordering Guide

**MT2E1 - 50**     A     -     B     - **188** -     C    

order code:

Sample Model Number:

**MT2E1 - 50E - 22 - 188 - M1**

**R** range: 50 inches  
**A** measuring cable termination: eyelet  
**B** measuring cable tension: 22 oz. (±6 oz.)  
**C** electrical connection: end-mounted connector



see fig. 2

### Measuring Cable Termination:

**A** order code:

**E**

Eyelet

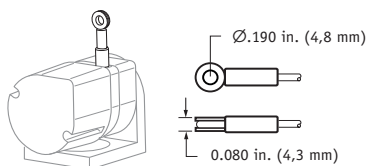

**L**

Leader Cable (24 in. long)

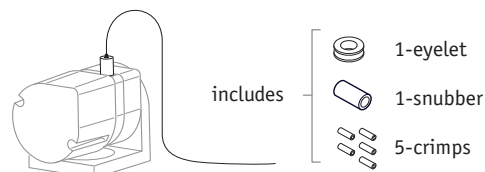

### Measuring Cable Tension:

**B** order code:

**9**

**14**

**33**

30-inch range option:	9 (±3) oz.	14 (±5) oz.	33 (±10) oz.
max. cable acceleration:	99 g	136 g	136 g
spring cycle-life, 80% extension:	≥ 1 million	150,000	75,000
spring cycle-life, 50% extension:	≥ 1 million	≥ 1 million	≥ 1 million

**B** order code:





**9**

**22**

50-inch range option:	9 (±3) oz.	22 (±7) oz.
max. cable acceleration:	46 g	68 g
spring cycle-life, 80% extension:	≥ 1 million	150,000
spring cycle-life, 50% extension:	≥ 1 million	≥ 1 million

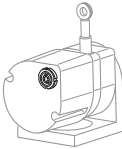
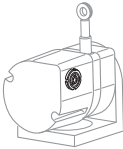
# Ordering Information (cont.):

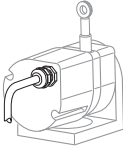
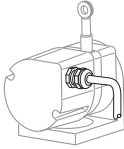
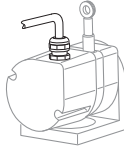
## Electrical Connection:

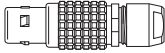
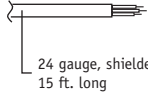
C order code:		M1	M1A	M2	M2A	M3	M3A											
sensor cover:		polycarbonate	aluminum	polycarbonate	aluminum	polycarbonate	aluminum											
electrical connection:		end-mount connector <i>mating plug included</i>			side-mount connector <i>mating plug included</i>			top-mount connector <i>mating plug included</i>										
C order code:		C1	C1A	C2	C2A	C3	C3A											
sensor cover:		polycarbonate	aluminum	polycarbonate	aluminum	polycarbonate	aluminum											
electrical connection:		end-mount instrumentation cable <i>15-ft. long, 24 gauge shielded</i>			side-mount instrumentation cable <i>15-ft. long, 24 gauge shielded</i>			top-mount instrumentation cable <i>15-ft. long, 24 gauge shielded</i>										
		 Lemo FGG.0B.304.CLAD52			 24 gauge, shielded, 15 ft. long			<table><thead><tr><th>color</th><th>signal</th></tr></thead><tbody><tr><td>Red</td><td>input voltage (V+)</td></tr><tr><td>Black</td><td>common (gnd.)</td></tr><tr><td>Green</td><td>channel A</td></tr><tr><td>White</td><td>channel B</td></tr></tbody></table>	color	signal	Red	input voltage (V+)	Black	common (gnd.)	Green	channel A	White	channel B
color	signal																	
Red	input voltage (V+)																	
Black	common (gnd.)																	
Green	channel A																	
White	channel B																	
contact view																		

## Accessories:

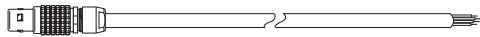

Part Number	Description
9603957-0015	15 ft. long cordset. Includes mating connector with 15 ft., 24 gauge, shielded multiconductor cable. Signals: V+, Gnd, Channel A, Channel B

**NORTH AMERICA**  
Measurement Specialties, Inc.  
a TE Connectivity Company

Tel +1-800-423-5483  
customer care.chtw@te.com

## te.com/sensorsolutions

Measurement Specialties Inc. a TE Connectivity company

Measurement Specialties, TE Connectivity, TE Connectivity (logo) and Every Connection Counts are trademarks. All other logos, products and/or company names referred to herein might be trademarks of their respective owners.

The information given herein, including drawings, illustrations and schematics which are intended for illustration purposes only, is believed to be reliable. However, TE Connectivity makes no warranties as to its accuracy or completeness and disclaims any liability in connection with its use. TE Connectivity's obligations shall only be as set forth in TE Connectivity's Standard Terms and Conditions of Sale for this product and in no case will TE Connectivity be liable for any incidental, indirect or consequential damages arising out of the sale, resale, use or misuse of the product. Users of TE Connectivity products should make their own evaluation to determine the suitability of each such product for the specific application.

© 2019 TE Connectivity Ltd. family of companies All Rights Reserved.