

## To endure field applications, these transducers feature a waterproof design, and high accuracy

The BLD-A-S series is compact and lightweight hollowed load cells designed to accurately measure the load applied to a PC anchor and rock bolt. To endure field applications, these transducers feature a waterproof design and high accuracy.

### Specifications

#### Performance

Rated Capacity	See table below.
Nonlinearity	Within $\pm 1\%$ RO
Hysteresis	Within $\pm 1\%$ RO
Rated Output	1 mV/V or more

#### Environmental Characteristics

Safe Temperature	-20 to 70°C
Compensated Temperature	-10 to 60°C
Temperature Effect on Zero	Within $\pm 0.1\%$ RO/°C
Temperature Effect on Output	Within $\pm 0.1\%$ /°C

#### Electrical Characteristics

Safe Excitation	10 V AC or DC
Input Resistance	350 $\Omega \pm 2\%$
Output Resistance	350 $\Omega \pm 2\%$
Cable	4-conductor (0.5 mm <sup>2</sup> ) chloroprene shielded cable, 9.6 mm diameter by 1 m long, bared at the tip (Shield wire is not connected to the case.)

#### Mechanical Properties

Safe Overloads	120%
Weight	See table below.

Models	Rated Capacity	$\phi A$	$\phi B$	$\phi C$	H	Weight (Approx.)
● BLD-A-50KNS	50 kN	10	22	50	60	200 g
● BLD-A-100KNS	100 kN	20	32	61	80	300 g
● BLD-A-200KNS	200 kN	20	42	61	80	600 g
● BLD-A-500KNS	500 kN	25	54	64	100	1.3 kg

● For delivery date, please contact us.

$\phi A$ : Hollow diameter

### ■ Dimensions

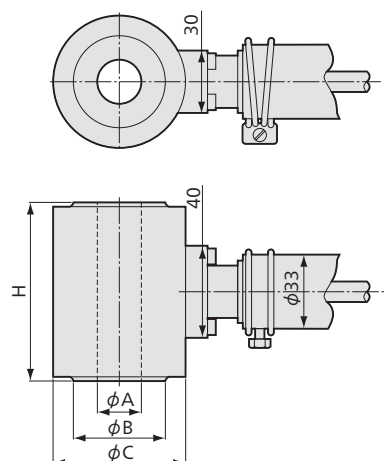

### ■ Application Example

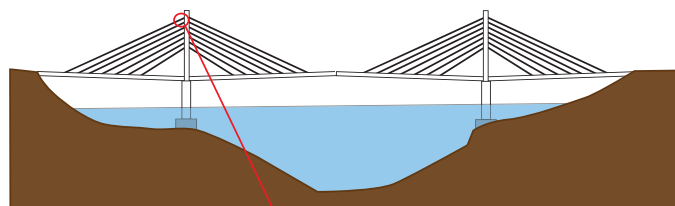

Tension measurement on anchoring cables of cable stayed bridge

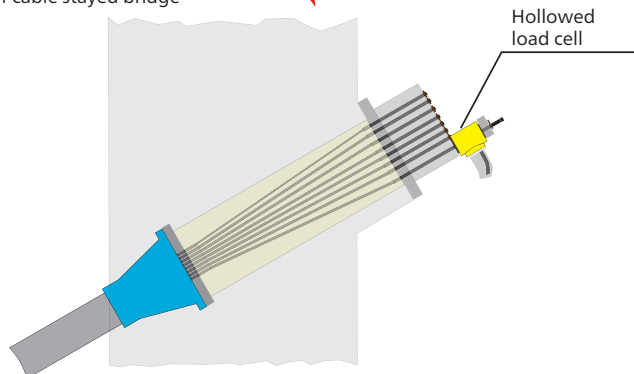

Hollowed load cell